

Goddard Geophysical and Astronomical Observatory

hosting a DORIS station since 1999



Site A →

Site B →

VLBI

Site D

Site C

Site F

Tour M.O.

Site E
DORIS
actuel



139 m
39°01'15.15" N 76°49'37.64" O

©2006 Google

mars 2006

Altitude 481 m

Pilier de
calibration
radar

Antenne
DORIS

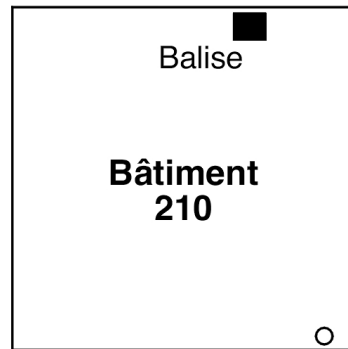

Station météo



Échelle : 0 5 m



Custom Fiberglass Communication Shelter



This fully insulated 8 x 12 fiberglass communication shelter was fabricated by VPC for the US Coast Guard for their communication equipment. This building was built with Radio Frequency Interference (RFI) shielding to protect the equipment stored inside. The floor is reinforced with a steel skid and is outfitted with heat, a/c, exhaust and mounting options. Fiberglass is an ideal composite material in conditions where salty sea spray and extreme weather conditions exist

Description

Fiberglass Insulated Shelter - 7 x 8 x 7 with 36 in x 80 in door. Includes FRP floor integral to the interior.

110/220V Load Center with 4-20amp Single Pull Breakers

60 Watt Incandescent Sealed Light w/ Interior Switch

500 Watt Stainless Steel Heater w/thermostat

60 CFM Exhaust Fan w/ thermostat

Air Conditioner Unit - 10,000 BTU

	task	who	when
1	temporary installation of the new shelter and cabling (power+internet)	Host agency ?	
2	moving of DORIS beacon	DORIS team	End of october
3	DORIS antenna support replacing	DORIS team	End of october
4	removing of the old shelter	Host agency ?	
5	definitive installation of the new shelter on part of the concrete basement and cabling (power+internet)	Host agency ?	
6	reinstallation of DORIS beacon	DORIS & REGINA team	
7	GNSS 2 meters mast installed on part of the concrete basement & global GNSS installation	DORIS & REGINA team	
8	local survey	DORIS & REGINA team	

Kokee Park Geophysical Observatory

hosting a DORIS station since 1990

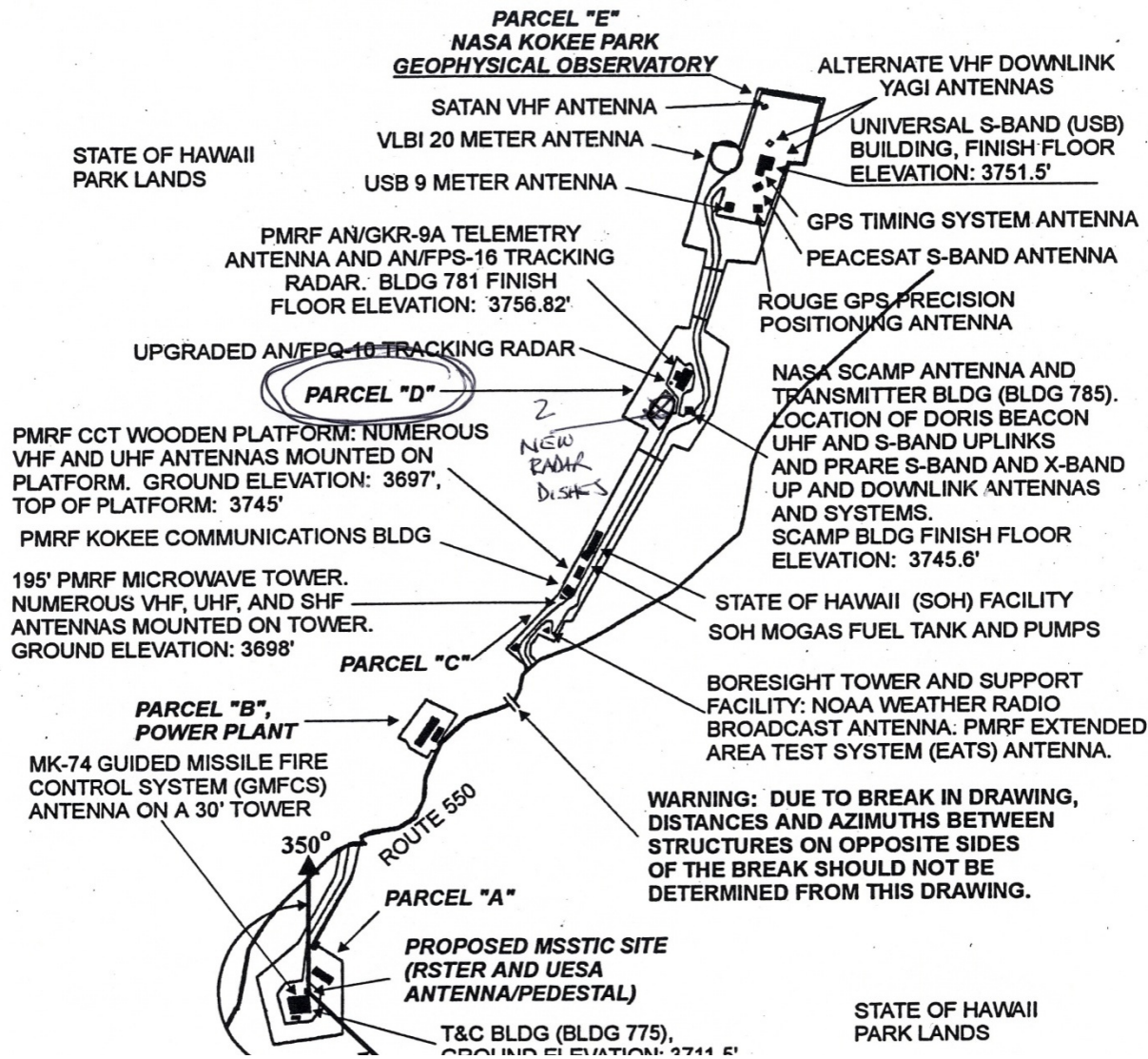



KAUAI



Data SOEST/UHM
Image © 2011 DigitalGlobe
Data SIO, NOAA, U.S. Navy, NGA, GEBCO
Image © 2011 TerraMetrics
22°07'32.51"N 159°39'49.85"O élév. 1105 m



2005

Haut-parleurs : muet

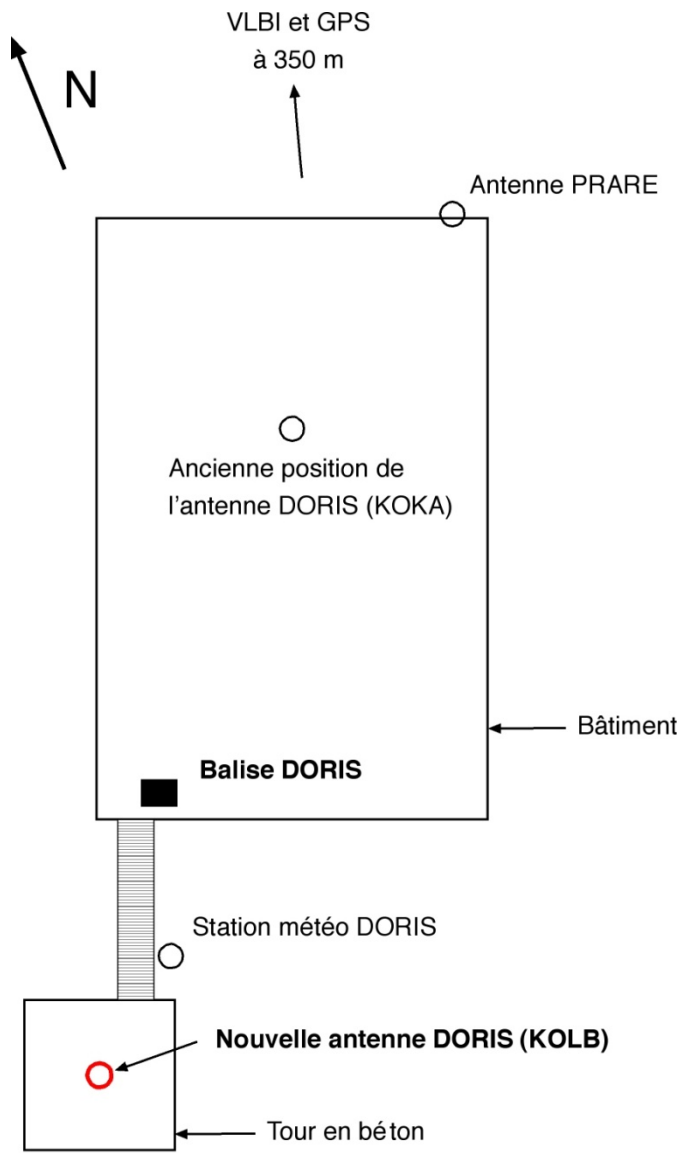

Échelle : 1:100



GOLDSTONE ?

Replacement of Monument Peak
DORIS initiative

AREQUIPA (PERU)

observatorio de Characato
University National of San Agustin
Agreement NASA / UNSA

Hosting a DORIS station since 1988

Our contact: Dr. Raul Yanyachi
Station Manager